

XbotGo Falcon

AI SPORTS CAMERA



User Manual

XbotGoTM
WWW.XBOTGO.COM

Table of Contents

Preface	3
Precautions	4
Package Contents and Optional Accessories	6
Package Contents	6
Optional Accessories	6
Product Overview	7
Understanding the XbotGo Falcon Camera	
Buttons and Functions	7
Preparation Before Use	16
1. Charging the Product	16
2. Download and Install the XbotGo App	17
Getting Started	19
1. Connecting Your Phone	19
2. Viewing the Device List	20
3. Changing Connected Devices	21
4. Installing a microSD (TF) Card	22
5. Installing the Tripod	24
6. Shooting Calibration	25
7. XbotGo RC1 Remote Control	26

Table of Contents

Shooting Instructions	34
Selecting Shooting Locations	34
Application Guide	36
XbotGo App	36
Firmware Upgrade	57
Upgrade Process	57
Technical Specifications	59
FAQ	61
1. LCD Icon Descriptions	61
2. Why is my XbotGo Falcon having tracking issues?	62
3. Can my XbotGo Falcon track a specific athlete?	63
4. My XbotGo Falcon won't turn on. What should I do?	63
5. My phone's Bluetooth is unable to connect to my XbotGo Falcon. How do I resolve this?	64
6. What's the general troubleshooting process for any issue?	66

Preface

Thank you for choosing the XbotGo Falcon camera.

The XbotGo Falcon camera is an AI-powered smart imaging device that integrates intelligent tracking, event live streaming, score recording, video editing, sports analysis, and cloud storage functions into one system. The product supports BLE (Bluetooth Low Energy) and Wi-Fi connectivity, featuring a dual-lens system design with the main camera as an independent HD module. It enables intelligent auto-tracking shooting.

This device is designed for both team and individual sports scenarios, offering powerful image processing capabilities, flexible tilt adjustment, and multi-camera collaboration support. Whether for personal training, professional game recording, or high-quality live broadcasting, the Falcon precisely captures every highlight moment on the field.

We hope that the XbotGo Falcon delivers an outstanding shooting experience and inspires you to explore new possibilities in sports and creative endeavors.

This manual includes important information regarding product usage, precautions, and maintenance. Please read it carefully before use to ensure safe, efficient operation and optimal performance. The images and descriptions in this manual are for reference only. Please refer to the actual product for accuracy. The copyright of this manual belongs to Suzhou Deep Foresight Technology Co., Ltd. Without the company's written permission, no organization or individual may copy, distribute, or modify any part of this manual in any form, nor use it for commercial purposes.

As the company continuously improves its products, specifications are subject to change without prior notice.

Precautions

In this manual, important information is categorized using the following symbols. Please read them carefully to better understand and use this manual.



Warning

Failure to follow instructions may result in personal injury or death.



Caution

Failure to follow instructions may result in equipment damage, performance degradation, or injury.



Note

Helpful tips and operational guidance for using this product effectively.

Before using this product, read the following precautions carefully:

- During startup, ensure your XbotGo Falcon camera can rotate freely without any interference.
- Before starting the product, ensure that it is securely mounted on a tripod to prevent falls, impacts, or compression that may damage the device.
- Handle with care to avoid drops or impacts, as this may affect normal operation.
- Do not use non-designated chargers, power adapters, or USB Type-C data cables to avoid damage to the product.

-
- Do not disassemble, repair, or modify this product yourself, as it may cause malfunctions.
 - Extended use may cause the device's motor to heat up. Handle with caution to avoid burns.
 - Store your XbotGo Falcon in a cool, dry environment.
 - Keep your XbotGo Falcon away from heat sources like stoves or heaters. Avoid storing in high-temperature areas (e.g., hot cars or rooms).
 - Keep the product out of reach of children and pets.
 - Avoid overcharging to prevent damage to the battery.
 - Use your XbotGo Falcon within the temperature range of 0°C to 40°C.

Package Contents and Optional Accessories

Package Contents



Main Device



USB Type-C
Data Cable



Water-resis-
tant Carrying
Case



Quick Start
Guide



Quick-release
Plate



Cleaning
Cloth

Optional Accessories



Weather Protection
Umbrella



XbotGo NT4
Tripod

If any accessories are missing or damaged, please contact customer support or the store where you purchased the product before discarding the packaging.

Product Overview

Understanding the XbotGo Falcon Camera Buttons and Functions

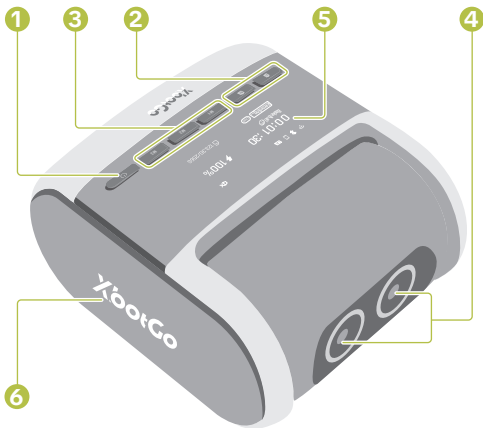

Product Overview

1 Power Button

When the power safety lock is in the "🔓" UNLOCK position, you can turn on the device by briefly pressing the power button.

After powering on, the LCD screen will display the startup animation, current battery level, and storage status.

When the power safety lock is in the "🔒" UNLOCK position, you can turn off the device by pressing and holding the power button.

The LCD screen will turn off, and the device will shut down.

Bluetooth Reset

Double-pressing the power button to reset Bluetooth, unpairing it from previously connected devices to allow quick pairing with a new device.

Lens Reset

Auto Reset — Each time you power the device on or off, the lens will then automatically return to the center position.

2 Main/Secondary Position Buttons

This feature is currently under development and will be gradually released through future firmware updates.

3 Buttons M1, M2, M3

Three preset shooting modes are available.

- M1 : Soccer
- M2 : Basketball
- M3 : Ice Hockey

Select the desired shooting mode button.

- Press and hold for 3 seconds to start recording.
- Press and hold for 3 seconds to stop recording.

* You may customize or restore the default settings as needed. For detailed configuration instructions, see page 51.

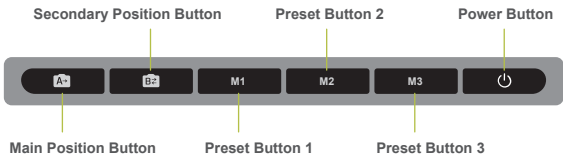

4 Camera

Supports dual-stream output: 4K30 for storage + 1080P30 for preview

Product Overview

5 LCD Screen

Displays relevant information based on user operations.

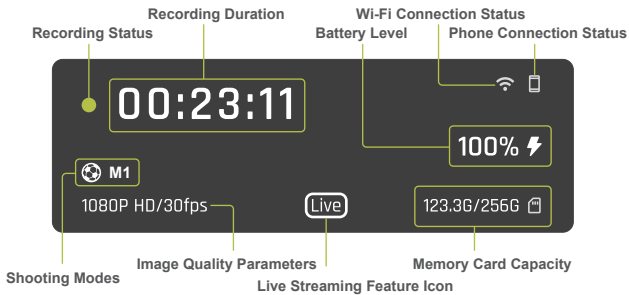

6 Side Light

Indicates different statuses depending on the operating scenario.

Side Light Status	General Scenarios
Slow pulsing light	Not connected to app after powering on
Solid light	Connected to app after powering on
Off	Entered sleep mode (after inactivity)

Side Light Status	General Scenarios
Flashes twice	Wake from sleep mode
Flashing white light	During factory reset

Side Light Status	Special Scenarios	 Side Light
Flashing red light	Not enough microSD (TF) card space during recording	
Flashing red light	microSD (TF) card error – failed to start recording	
Flashing red light	Low Battery (5%)	

Product Overview

Beep Notification

Sound	Cause	Description
Two short beeps	microSD (TF) card full during recording	Recording stops automatically when insufficient storage is detected, and the captured video is saved.
One short beep	Recording notification	Start/stop recording
Two short beeps	Low battery warning	Battery below 5%

Button Combination Function

Restore Factory Settings	Press and hold both the Main Position and M1 buttons for more than 10 seconds. The logo on the LCD screen will start flashing, indicating the camera is entering reset mode. Once the logo stops flashing, the device has been restored to factory settings.
Wake Function	Press any button to wake the device from sleep mode.

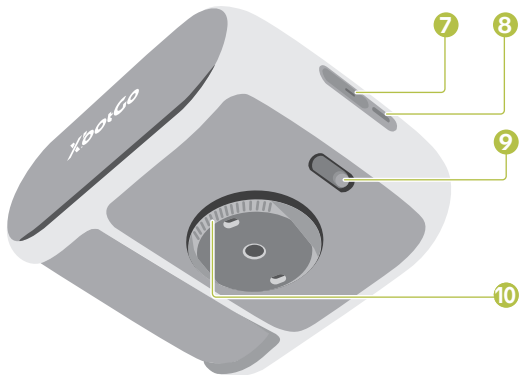

7 Memory Card Slot

It is recommended to use a professional-grade high-speed microSD (TF) card designed for action cameras and 4K video recording.

Product Overview

8 Type-C Charging Port

- It is recommended to use a power adapter that supports PD fast charging protocol (sold separately). This product supports up to 18 W fast charging.
 - Please use the original USB Type-C data cable to charge this product.
 - The LCD screen will display charging status during normal operation.
 - If the charging status is not displayed, please check whether the adapter and cable are properly connected.
 - Charging time: 3 hours*
 - Usage time: 4 hours*
- * The above data is provided by Deep Foresight Laboratory. Actual results may vary slightly depending on testing conditions.



Note

We recommend using an SD card reader and a USB Type-C adapter to transfer data directly to your smartphone or computer.

9 Power Safety Lock

- The power safety lock helps prevent accidental presses of the power button.
- If the power safety lock is switched to the "🔒" LOCK position during camera recording, it will not affect the recording status, but the power button will be disabled to prevent accidental shutdown.



To shut down the device when the power safety lock is in the "🔒" LOCK position, first switch the power safety lock to the "🔓" UNLOCK position, then press the power button.

10 Rotating Base

Supports 360° stepless horizontal rotation. It can also be used with the included quick-release plate.

Preparation Before Use

1. Charging the Product

- Use the included USB Type-C data cable to charge the product through the rear port.
- During charging, the LCD screen will display the charging status (battery percentage).
- The charging time is approximately 3 hours, and the fully charged device can operate for about 4 hours.
- If the LCD screen does not display the charging status, check whether the power adapter and cable are properly connected.



 **Caution**

- It is recommended to use a power adapter that supports PD fast-charging protocol (sold separately) together with the included USB Type-C data cable.
- Handle the cable with care when plugging or unplugging to avoid damage to the product or components.
- Do not overcharge this product to prevent potential battery cell damage.

2. Download and Install the XbotGo App

Search for "XbotGo" in the app store or scan the QR code to download and install.



iOS 15.0 or later



Android 10.0 or later

Preparation Before Use

Before getting started, please ensure the following:

- (1) The device is fully charged.
- (2) A memory card is properly inserted and has sufficient available space.
- (3) The XbotGo Falcon camera is securely mounted on a tripod to prevent accidental falls.
- (4) The power safety lock is in the "🔓" UNLOCK position.

Getting Started

1. Connecting Your Phone

- (1) Slide the power safety lock to the "UNLOCK" position, briefly press the power button to start the Falcon camera; Enable Bluetooth on your phone and launch the XbotGo app.
- (2) The XbotGo app will automatically search for and detect the Falcon camera. Tap [Connect] to complete pairing. Once paired successfully, the XbotGo app will automatically connect in future sessions without requiring manual confirmation.

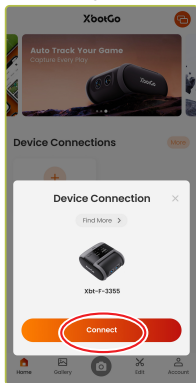
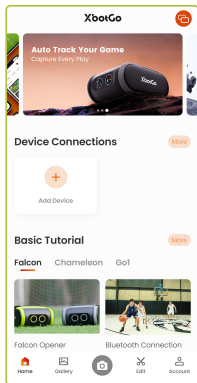

Getting Started

2. Viewing the Device List

- (1) After a successful connection, tap [More] to enter the device list screen.
- (2) On the device list screen, tap the corresponding device icon to view its detailed information.

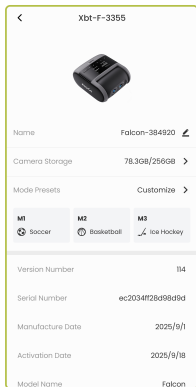
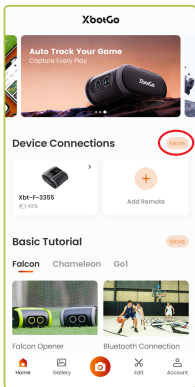

3. Changing Connected Devices

- (1) In the device list, you can either disconnect an already connected device or tap the [Connect] button to link a new available device.
- (2) If you attempt to connect a new device while another one is already connected, a prompt will appear. Select [Confirm] to switch to the new device, or [Cancel] to keep the current connection.

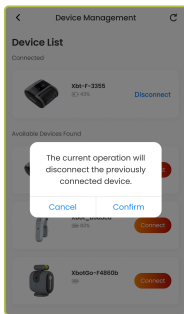
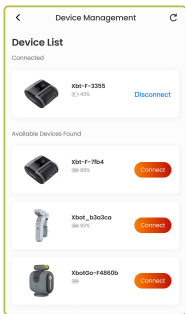

Getting Started

4. Installing a microSD (TF) Card

The microSD (TF) card slot is located on the back of the device. Follow the steps below to install the microSD (TF) card.

- (1) Open the protective cover of the microSD (TF) card slot on the back of the device.
- (2) Insert the microSD (TF) card in the direction shown in the diagram.
- (3) To remove the microSD (TF) card, gently press it inward until it pops out slightly, then pull it out.
- (4) Close the protective cover securely after installation.

- * Recommended cards: SanDisk Extreme / Lexar Professional 1066x / Samsung PRO Plus, or other high-speed microSDXC UHS-I U3 V30 or above.
Supported capacity: up to 1 TB





Caution

- Do not use low-speed or non-microSD storage devices.
- The microSD (TF) card may become hot after prolonged use. Handle with care when removing it from the device.
- Do not remove or power off the device while formatting the microSD (TF) card, or when recording, deleting, or transferring data. Doing so may cause data loss or damage to the device or card.
- Keep the microSD (TF) card away from liquids to prevent damage.
- Do not bend, drop, or scratch the microSD (TF) card with fingers or metal objects. Otherwise, it may be damaged.
- Do not expose the microSD (TF) card to water, high temperatures, or direct sunlight.

Getting Started

5. Installing the Tripod

- (1) Attach the tripod using the 1/4-inch screw mount located at the bottom of the quick-release plate.
- (2) Install the quick-release plate to the bottom of the Falcon camera. Ensure the alignment pin [1] on the quick-release plate matches the locating hole [2] on the Falcon camera, then turn the locking knob [3] clockwise to secure it.

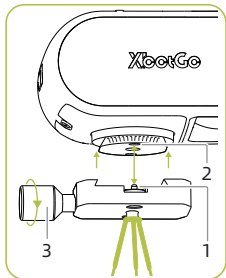
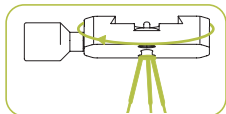

6. Shooting Calibration

Calibration can be performed in either of the following two ways. Choose the method that best fits your needs.

6.1 Calibration via Hardware Operation:

After the tripod is set up, press and hold the M1/M2/M3 button, and then the Falcon camera will automatically enter the calibration process (no manual intervention required). Once calibration is complete, place the camera in the desired shooting position before the countdown ends (default: 60 seconds) and prepare to start recording.

6.2 Calibration via Software Operation:

After confirming that the tripod is set up and the phone is paired with the Falcon camera, select a shooting mode and tap [Start Recording], and then the camera will automatically enter the calibration process (no manual intervention required). Once calibration is complete, follow the app prompts to place the camera in the desired shooting position and prepare to start recording.

A rounded rectangular button with a gradient from orange to red, containing the text "Start Recording" in white.

Caution

After calibration is completed, do not physically force the Falcon body. If you need to adjust the shooting angle or position, please do so by adjusting the tripod.

Getting Started

7. XbotGo RC1 Remote Control

7.1 Remote Control Specifications

 The image shows a white, vertically-oriented remote control with a central joystick and four directional buttons (up, down, left, right). At the bottom, there are two buttons: a black one with a power symbol and a red one with a stop symbol. The word "Xbot" is printed at the very bottom.	Model	XbotGo RC1
	Battery Type	CR2032
	Signal Range	10 m
	Operating Environment	-5°C to 60°C

* The remote control is an exclusive accessory for the Kickstarter version only.

7.2 Quick Start Guide

- (1) Open the battery compartment cover, remove the insulation tab from the bottom of the battery, insert the battery, and close the cover.
- (2) Before first use, perform Bluetooth pairing. Press and hold the power button for 3 seconds to turn the remote control on/off.
- (3) After turning on the remote controller, the [Phone Connection Indicator] will flash red.
- (4) Open the XbotGo app near your device, select "XbotGoR-F-XXXX" in the XbotGo app to pair. Once connected, the indicator turns blue.

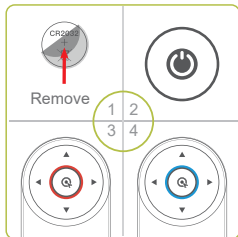

Getting Started

- (5) **Out-of-range signal**
When the indicator flashes red, the remote control is disconnected. If it reenters the reception range within 1 minute, the blue light will turn on and the remote will automatically reconnect.
- (6) **Sleep and Power-off**
If there is no operation for more than 3 seconds, the remote will enter sleep mode. Press any button during sleep mode to reconnect. If idle for more than 30 minutes, the remote will automatically power off. Press the power button again and move closer to the device to reconnect.

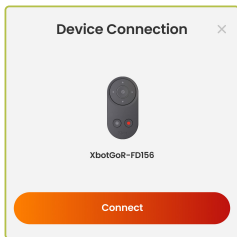

Caution

During use, remote disconnection affects only remote control operations and will not interrupt the current recording or program. If the XbotGo app cannot detect the remote control, press and hold the power button for 3 seconds to power it off, then press and hold again for 3 seconds to restart and re-pair it for normal use.

7.3 XbotGo RC1 Remote Control

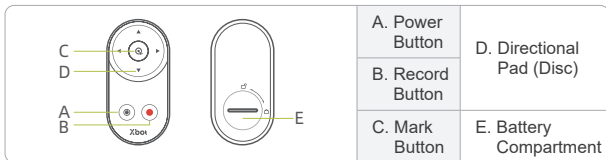

7.4 Buttons and Functions

Before using the remote control, please familiarize yourself with its functions.

7.4.1 Power Button



Press and hold the power button for 3 seconds to turn the remote control on/off.

XbotGo Falcon Camera Centering

Double-press the power button to automatically center the XbotGo Falcon camera (restore default view angle). If the auto-tracking mode is enabled during recording, the Falcon camera will continue tracking after recentering.

Getting Started

7.4.2 Bluetooth Pairing



Press and hold the power button to power on, then open the XbotGo app to connect the remote control.



- **Status Indicator:** (1) Flashing red – not connected.
(2) Solid blue – successfully connected.
- **Power-Saving Mode:** The indicator light will automatically turn off after 3 seconds of inactivity and will wake immediately upon any button press.

7.4.3 Remote Control Reset



While the remote control is powered on, press and hold the Mark button for more than 3 seconds to reset the remote control.

7.4.4 Recording Function



The red button is used to start, pause, resume, or stop recording.

- **Start Recording** Press once — a single "beep" sound will be heard, and the blue breathing light will pulse slowly — recording begins.
- **Pause Recording** During recording, press once — a double "beep-beep" sound will be heard, and the blue breathing light will flash rapidly — recording is paused.
- **Resume Recording** While paused, press once — a single "beep" sound will be heard, and the blue breathing light will pulse slowly — recording resumes.
- **Stop Recording** Press and hold for 1.5 seconds — a long "beeeep" tone will play, and the blue indicator will return to solid — recording stops.

Getting Started

7.4.5 Directional Control



On the recording screen, press the Up, Down, Left, or Right buttons to adjust the camera direction accordingly.

- **Short Press**

Briefly press a directional button, the lens moves slightly in that direction and stops automatically.

- **Long Press**

Press and hold a directional button, the lens continues moving in that direction until the button is released.

7.4.6 Mark Function (Video Recording Mode Only)



You can manually mark key moments during recording to make it easier to locate and edit highlights later.

- **Successful Mark**

After recording begins, press the Mark button, the remote emits a confirmation tone indicating a successful mark.

- **Invalid Mark**

If recording is paused or stopped, pressing the Mark button will trigger a red light flash and an alert sound. The mark will be invalid, and the command will be ignored automatically.

7.5 Battery

The remote control uses a CR2032 coin cell battery.

To ensure optimal performance:

- Do not use any other type of battery.
- If the remote control will not be used for more than two months, remove the battery.
- Do not dispose of the battery with household waste. Dispose of it properly in accordance with local regulations.



Warning

This product contains a button battery that includes hazardous substances. Do not swallow. Keep the battery out of reach of children. Swallowing a battery can cause chemical burns, tissue perforation, or even death. Serious burns may occur within two hours of ingestion. Seek medical attention immediately.

7.6 Remote Control Precautions

- The remote control must be used within 10 meters of the connected smartphone.
- When a remote signal is received, Falcon will display a remote connection notification on the device.

Shooting Instructions

Selecting Shooting Locations

1. Recommended Shooting Locations for Sports Events

When filming sports events, it is recommended to place your XbotGo Falcon camera near the center line of the field. This position offers a superior shooting angle, allowing you to better capture the full action and key highlights of the game.



(Example of a soccer field)

2. Steps to Ensure Full-Field Coverage

To ensure that your XbotGo Falcon camera can effectively cover the entire field in all game modes (excluding basketball half-court mode), please follow the steps below:

- (1) Confirm the tracking range: ensure that your XbotGo Falcon camera can fully monitor the entire play area to avoid any blind spots in footage.
- (2) Optimize device placement: adjust the position of your XbotGo Falcon camera to ensure it can clearly and stably capture all key actions during the game.

3. Tips for Avoiding Obstruction by Spectators

To prevent the camera view from being blocked by spectators, consider the following recommendations:

- (1) Increase your XbotGo Falcon height or reposition near the sidelines: raise the tripod to the suggested height and position it near the field's sidelines.



Caution

Raising the device during shooting may cause the tracking to fail.

- (2) Monitor nearby spectators: during recording, keep a close eye on spectators near your XbotGo Falcon camera. If necessary, actively adjust the device or reposition yourself to ensure the camera's line of sight remains clear, thereby maintaining optimal recording quality.



Caution

After calibration is completed, do not physically force the Falcon body. If you need to adjust the shooting angle or position, please do so by adjusting the tripod.

Application Guide

XbotGo App

The Falcon camera must be used with the XbotGo app, which displays real-time footage on your smartphone and supports features such as automatic tracking and manual recording.

1. App Connection

- (1) Enable Bluetooth in your phone settings.
- (2) Register and log in to your XbotGo account.
- (3) Open the XbotGo app and enter the main screen. To ensure proper operation, please enable all requested permissions as prompted. All permissions are used solely for product functionality. Your privacy and data security are strictly protected.
- (4) The app will search for the XbotGo device named "Xbt-F-XXXX." Once found, select it to establish a connection. If not found, check your phone's Bluetooth settings or confirm that the device is not paired with another phone.

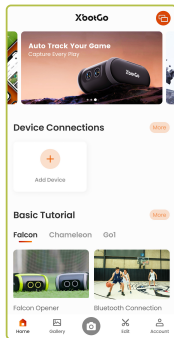

Note

Double-press the Falcon camera's power button to reset Bluetooth, disconnecting from the previously paired phone for quick reconnection with a new one.

- (5) When the XbotGo device is connected for the first time, a pairing reminder will appear. You can choose whether to connect. After a successful pairing, the XbotGo app will automatically connect during future use without requiring further confirmation.

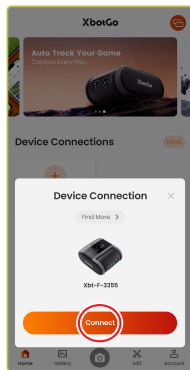

- (6) If no pairing prompt appears, try locating and tapping the "📷" button at the bottom of the app interface.



Application Guide

- (7) Once connected, the Falcon camera icon and device name will be displayed on the XbotGo app's main interface.
- (8) You can tap "+" to add an additional remote control.



Note

Only one camera device and one remote control can be connected at the same time.

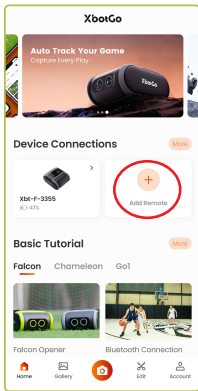

2. Recording

After connecting to your phone, you can select a sport in the app and enter recording mode.

3. Shooting Interface Overview

Once in the shooting interface of the XbotGo app, tap the corresponding on-screen icons to access specific features or adjust parameters.



3.1 Photo Capture



Tap this button during recording to capture and save the current frame as a photo.

Application Guide

3.2 Mark Function



During a game, tap the [Mark] button to record key moments (e.g., goals) in real time. These markers can later be used to quickly locate highlights during editing.

3.3 Live Sharing



This button appears only after entering the live streaming mode. Tap it to invite others to watch your live broadcast.

3.4 Recording Function



Tap the red Record button to start or stop automatic tracking and video recording.



Tap the Pause button to temporarily pause video recording.

3.5 Zoom Adjustment



To ensure optimal tracking and image quality across various scenarios, each shooting mode in the app is preset with a different zoom level.

3.6 Scoreboard Function



Allows manual recording and modification of match scores. Tap the button to enter team names, scores, and other information. The data will be synced and displayed on the main recording device.

There are four scoreboard styles available:

General, Soccer, Basketball, and Ice Hockey.

The displayed style corresponds to the selected sport mode. All modes except Soccer, Basketball, and Ice Hockey use the General style.

Application Guide

3.7 Starting a Live Stream



Tap the Live button, then follow the system prompts to choose a thumbnail and enter a live title.

The stream will be broadcast on the XbotGo platform. You can share the live link with others or set a viewing password to limit access.

Live Streaming Settings

- (1) After setting the live room name, thumbnail, and password (all optional), tap [Other Streaming Options] to select Facebook or YouTube live streaming.

For local streaming, skip directly to step (3) for further instructions.

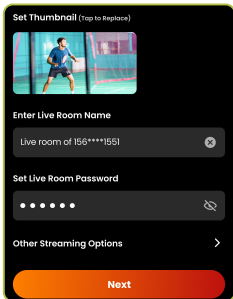

(2) Other Streaming Options

Facebook Live:

- 1) Tap [Go to Bind], then follow the app instructions to bind your Facebook account.
- 2) After successful binding, select Facebook and tap [Next].



Caution

If you have not logged into Facebook Live for a long time, you may need to rebind before using it again.

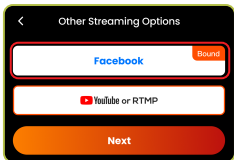
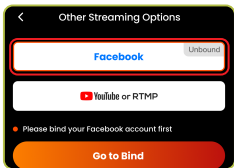

Application Guide

Friendly Reminder:

Starting June 10, 2024, Facebook Live streaming must meet the following requirements to broadcast to Pages and Professional Mode profiles:

- a. Your Facebook account must be at least 60 days old.
 - b. Facebook Pages and Professional Mode profiles must have at least 100 followers. Please ensure your account meets these requirements and has live streaming privileges.
- 3) After entering the title and description, you can select a sharing option — Public, Friends, or Private — then tap [Next] to proceed to network configuration.

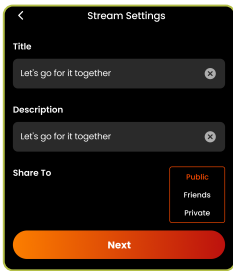

YouTube Live:

Select YouTube or RTMP and tap [Next]. Log in to YouTube using a computer or mobile browser (for mobile login, open your browser and rotate your phone to landscape mode). Once logged in, tap the settings icon in the top-right corner to switch to desktop mode. Copy and paste your channel's streaming URL and key into the corresponding fields in the XbotGo app. Tap the Start Live and Record buttons to begin streaming. Pausing the stream may result in a black screen during live broadcast.

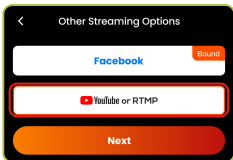

Application Guide

(3) Livestream Settings

On the network configuration screen, select [Resolution] to set image quality, then connect to Wi-Fi and tap [Start Livestream] to begin streaming.



Note

Ensure both Falcon and your smartphone are connected to the same Wi-Fi network, or use your phone's hotspot for network access.



Caution

Select either [Device Hotspot] or [Public Wi-Fi] and connect accordingly.

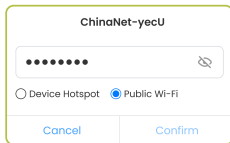
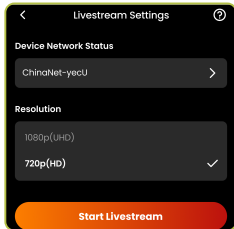

- (4) If there is no network connection or a connection failure occurs, a prompt will appear. Tap [Confirm] and reconnect to the network.

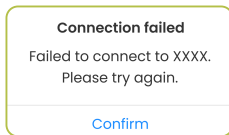

3.8 Direction Controller



Used to control the camera's viewing angle.

Tap the button to display the on-screen direction controller. You can drag the white dot on the controller or tap the directional arrows on the screen to remotely control the movement of the main device (Falcon camera).

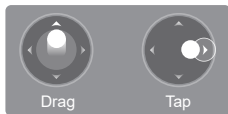

Application Guide

3.9 Hide Interface



Tap this button to show or hide all control icons on the shooting interface.

3.10 Shooting Settings



Used to adjust various shooting parameters.

After making changes, tap [Save Current Settings] to ensure modifications take effect. To restore factory defaults, tap [Restore Default Settings].

General Settings

Time Watermark Settings	Enabled by default; can be turned off if needed.
Audio Recording	Enabled by default; can be turned off if needed.
Clarity	1) Default 1080p HD. 2) Optional shooting resolutions: 4K, 1080p, 720p. 3) Users recording in 1080p can manually upgrade to 4K.
Auto Zoom Mode	Enabled by default. When enabled, the device automatically adjusts focus distance based on the scene and timing.
Auto Tracking Mode	Enabled by default; can be turned off if needed.

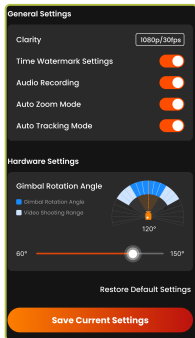

Application Guide

Hardware Settings

Gimbal Rotation Angle



This setting limits the horizontal rotation angle to prevent excessive movement or misjudgment. You can manually adjust the rotation range as needed.

- 1) Supports 60°–150° rotation range. If [Auto Tracking Mode] is disabled, the device will stop rotating.
- 2) The red area represents the camera's rotation range; the blue area represents the visible shooting range.

4. Mode Presets

You can tap [Customize] to modify and save personalized mode presets according to their needs.

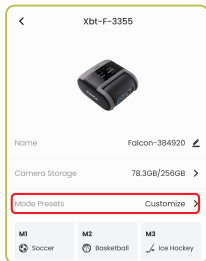

4.1 Modes and Scenarios

- **Mode labels:** M1 (currently selected), M2, and M3 — each can be preset for different sports scenarios.
- **Sports Mode:** Cover soccer, basketball, ice hockey, handball, and tennis.

4.2 Basic Scene Parameters

- **Field Size:** Small 5v5 (selected), Medium 7v7, Large 11v11 — suitable for different game scales.
- **Age Group:** Over 14 (selected), Under 14 — distinguishes youth from adult activity levels.

4.3 General Settings

- **Time Watermark Settings:** On (records shooting time)
- **Audio Recording:** On by default
- **Clarity:** 1080 p / 30 fps (resolution + frame rate)
- **Auto Functions:** Auto Zoom Mode and Auto Tracking Mode On (assist in tracking moving subjects)

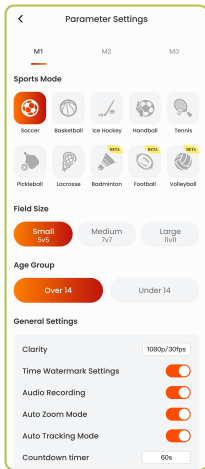

Application Guide

- **Auto Save Duration:** 30 minutes
- **Countdown timer:** Default is 60 seconds; can be customized within a range of 30-120 seconds.
(During the countdown before shooting: The breathing light will flash white slowly to indicate that the countdown is in progress.
When the countdown ends / shooting begins: The breathing light will flash white rapidly three times, and a long beep will sound during the final 1 second. Recording starts when the beep finishes.)

4.4 Hardware Parameters

Device Rotation Angle: Default value varies by shooting mode; adjustable range: 60°–150°. Determines the horizontal coverage range of the camera.

4.5 Operation

Tap [Restore Default Settings] to reset parameters or [Save] to confirm the current configuration.

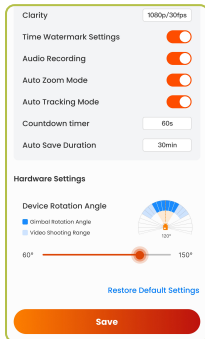

5. Basketball Single-Player Tracking (Beta Version)

This feature uses jersey number recognition for single-player tracking. The system automatically identifies and locks onto the athlete wearing the selected jersey number for precise tracking and recording.

5.1 Operation Procedure

(1) Add Jersey Number (must be entered before each use)

- Go to [Basketball — Single Mode] → Select [Jersey Number] → Enter the athlete's jersey number.
- Capture photos: Take full-body front and back photos of the athlete wearing the selected number.
(For better accuracy, take photos in a well-lit, clean basketball court without visual obstructions.)

Application Guide

(2) Device Placement

Place the device at the center of the court sideline to ensure full coverage of the athlete's movement.

Full-Court Shooting

Align the camera's center point **with the centerline of the field** to ensure full coverage of the playing area.

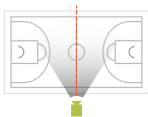

Half-Court Shooting

Align the camera's center point **with the basket** to ensure complete tracking coverage of the half court.



Once preparation is complete, tap [Start Shooting]. The XbotGo device will automatically track the athlete wearing the specified jersey number.

6. Video Saving and Editing

The video editing feature is available in the [Edit] section. After editing, videos can be shared directly to various platforms.

6.1 Add Videos

Tap [New Project] to add a new editing task.

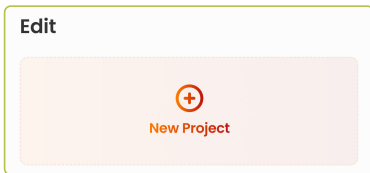

6.2 Combine and Export

Select at least 2 and up to 5 video clips to merge into a single long video and export it to your local album. You can manually drag and rearrange clips in the editing timeline.

6.3 Select [Mark Editing]

Mark Editing is used to tag key points in a video to highlight specific moments for quick location and export during post-editing.

Select at least one and up to five video clips to enter the Mark Editing page.

Application Guide

Manual Mark Editing:

- You can manually add or delete mark points on this page and set the clip duration before and after each mark. After export, a highlight video composed of these marked segments will be generated.
- Default clip duration for mark editing: 2 seconds before and 4 seconds after each mark point. You can manually adjust these values. Once saved, the new settings will be applied to subsequent edits.

Basketball AI Mark Editing:

- When editing basketball videos recorded with XbotGo devices, the system can use AI to automatically identify highlights while still supporting manual marking. After export, a basketball highlight video will be automatically generated using AI-detected moments.
- AI Marking Accuracy: [Precision Mode] is used by default, providing more accurate results but requiring longer processing time. [Quick Mode] offers shorter analysis time but less detailed results.
- During AI analysis, you cannot change mark accuracy, clip order, or add/delete videos.



Caution

Ensure at least 2 GB of available memory; otherwise, editing cannot be completed. If the video files are large, more storage space may be required to finish processing successfully.

Firmware Upgrade

Upgrade Process

1. Receive Upgrade Notification and Start Upgrade

When new firmware is available, the app will notify you with an upgrade prompt. After tapping [Firmware Update], the Falcon camera will automatically perform the upgrade.



2. During Upgrade

After selecting upgrade, the app will automatically complete firmware download, installation, and verification. Tap [Confirm] after verification and wait for the upgrade result.

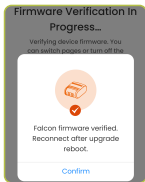

Firmware Upgrade

3. Upgrade Result

Once the Falcon camera finishes upgrading, it will restart automatically. Wait for the app to reconnect and confirm whether the upgrade was successful or not.

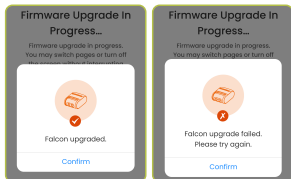

4. Manual Upgrade

If you missed the app's pop-up notification, go to the device list and tap [Firmware Upgrade] at the bottom to perform a manual upgrade.

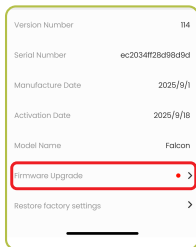

Technical Specifications

General

Dimensions	134 × 116 × 76 (mm)
------------	---------------------

Weight	808 g
--------	-------

Preview Maximum Resolution	1920 × 1080
----------------------------------	-------------

Download Maximum Resolution	3840 × 2160
-----------------------------------	-------------

Camera

Mechanical Rotation Range	Horizontal: Infinite 360°
---------------------------------	---------------------------

	Tilt: 160°
--	------------

Wireless Mode

Wi-Fi Type	Wi-Fi 6
------------	---------

Bluetooth Mode	Bluetooth 5.2
-------------------	---------------

Software



App	XbotGo
-----	--------

Technical Specifications

Battery	
Type	Lithium Battery
Rated Capacity	9200 mAh
Energy	3312 mWh
Voltage	3.5 V – 4.2 V (standard 3.6 V)
Charging Power Supply	5 V / 3 A, 9 V / 2 A, 12 V / 1.5 A DC
Operating Time	4 hours*
Charging Time	3 hours*
Camera Charging Port	Type-C

* The above data is provided by Deep Foresight Laboratory. Actual results may vary slightly depending on testing conditions. The company continuously updates and improves its products; specifications are subject to change without prior notice.

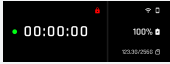
1. LCD Icon Descriptions

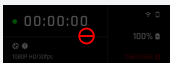
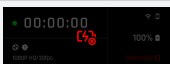
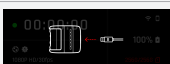
Icon	Description
	Appears when the power safety lock is in the locked position.
	Appears when the power safety lock is locked and M1/M2/M3 is pressed, or when recording is started from the app shooting interface.
	Appears when the SD card has insufficient storage space or the SD card format is invalid.
	Appears when the battery temperature is too high, and recording is paused.
	Appears when a charger is connected in an environment below 0°C.
	Appears when the device is not charging properly.

FAQ

2. Why is my XbotGo Falcon having tracking issues?

- Your XbotGo Falcon has low battery. Please ensure it is fully charged before use.
- Bluetooth pairing error. Avoid pairing with multiple devices simultaneously.
- Improper placement or angle of the device. Please refer to the camera placement guidance in the app.
- Incorrect selection of venue and sport type. Please ensure the subject, venue, and shooting mode are all set consistently.
- Interference from crowds along the court sidelines. Position the device along the sidelines and away from crowded areas for optimal performance.

3. Can my XbotGo Falcon track a specific athlete?

- In basketball shooting mode, tracking a specific player can be achieved through the jersey number tracking feature in FollowMe mode. Note: This feature is currently in beta phase, and tracking performance may be unstable.

4. My XbotGo Falcon won't turn on. What should I do?

- Charge for 3 hours, then press and hold the power button for 10 seconds to force restart the device. Check whether it powers on successfully.
- Make sure the power safety lock is in the unlocked position, and fully charge the device using a compliant PD power adapter.

FAQ

5. My phone's Bluetooth is unable to connect to my XbotGo Falcon. How do I resolve this?

- Can you see your XbotGo Falcon's Bluetooth name (Xbt - F - XXXX) in the XbotGo app device list?

a. Yes

- Ensure your XbotGo Falcon is fully charged.
- Click the Refresh button at the top right corner of the device management page.
- Close and reopen the XbotGo app.
- Reset your XbotGo Falcon's Bluetooth by double-pressing the power button and try again.
- Restart the device and try again.
- If your XbotGo Falcon's side light is solid, this means it is connected to another phone. Please disconnect it and try again.
- Check if there are too many connections in your phone's Bluetooth history. Try removing or forgetting some devices and try again.
- Update the XbotGo app to the latest version.

b. No

- Ensure your XbotGo Falcon is fully charged.
- Check your phone settings to ensure the XbotGo app has Bluetooth permission. If not, please grant permission.
- Ensure your phone's Bluetooth is turned on. If not, please turn it on.
- Turn off your phone's Low Power mode/Do Not Disturb mode.
- Reset your XbotGo Falcon's Bluetooth by double-pressing the power button.
- Restart the device.
- Close and reopen the XbotGo app.
- If your XbotGo Falcon's side light is solid, this means it is connected to another phone. Please disconnect it and try again.
- Check your phone's Bluetooth history to see if there are too many connections. Try removing or forgetting some devices.
- Update the XbotGo app to the latest version.

FAQ

6. What's the general troubleshooting process for any issue?

- For most issues, start by restarting both the device and the app.
- If the problem continues, try resetting the Bluetooth connection and reconnecting the device.

XbotGo Falcon

AI SPORTS CAMERA

User Manual

XbotGo™
WWW.XBOTGO.COM



If there are updates, you will not receive separate notifications.
For more information, please visit the official Blink Tech website.
www.xbotgo.com

Version 2.3 March 2026